

CLERK'S OFFICE  
**AMENDED AND APPROVED**  
Date: 10-22-02

Submitted by:  
Prepared by:  
For reading:

Chairman of the Assembly at the  
Request of the Mayor  
Planning Department  
October 22, 2002

Anchorage, Alaska  
AR 2002-319

1 A RESOLUTION OF THE ANCHORAGE MUNICIPAL ASSEMBLY APPROVING A  
2 CONDITIONAL USE FOR AN ALCOHOLIC BEVERAGES CONDITIONAL USE IN  
3 THE PLI-P DISTRICT FOR A GOLF COURSE – SEASONAL LICENSE PER AMC  
4 21.40.160, FOR ANCHORAGE GOLF COURSE LLC, D.B.A. ANCHORAGE GOLF  
5 COURSE, LOCATED ON SECTION 16 SUBDIVISION, TRACT C; ON THE NORTH  
6 SIDE OF O'MALLEY ROAD AND EAST OF LAKE OTIS PARKWAY.

7  
8 (Abbott Loop Community Council) (Case 2002-192)  
9

10  
11 **THE ANCHORAGE ASSEMBLY RESOLVES:**  
12

13 **Section 1.** The conditional use permit for an Alcoholic Beverages Conditional Use in the  
14 PLI-p District for a Golf Course – Seasonal license per AMC 21.50.160, for Anchorage  
15 Golf Course LLC d.b.a. Anchorage Golf Course, located on Section 16 Subdivision,  
16 Tract C; on the north side of O'Malley Road and east of Lake Otis Parkway, meets the  
17 applicable provisions of AMC 21.50.020 and AMC 21.50.160.  
18

19 **Section 2.** The conditional use permit for an Alcoholic Beverages Conditional Use for a  
20 Golf Course license - Seasonal is for 200 acres for the Anchorage Golf Course snack bar  
21 area of the clubhouse and 18 hole public golf course.  
22

23 **Section 3.** The conditional use permit is approved subject to the following conditions:  
24

- 25 1 A notice of Zoning Action shall be filed with the District Recorders Office within  
26 120 days of the Assembly's approval of a final conditional use approval for a golf  
27 course – seasonal license in the PLI-p District.  
28
- 29 2. All uses shall conform to the plans and narrative submitted with this conditional  
30 use application.  
31
- 32 3. This conditional use approval is for an Alcoholic Beverages Conditional Use in  
33 the PLI-p District for a Golf Course – Seasonal license per AMC 21.50.020 and  
34 21.50.160 for 200 acres, Anchorage Golf Course snack bar area of the clubhouse  
35 and the 18 hole public golf course, Section 16 Subdivision, Tract C.  
36
- 37 4. On-premise sale of alcohol beverages seven (7)-days a week, Monday thru  
38 Sunday, limited to the hours the golf course is in use, ~~9:00 AM to 9:00 PM.~~  
39 10:00 2:00 A.M.  
40
- 41 5. The golf course alcohol license is limited to sales of beer and wine.

- 1 6. The golf course license will only operate on a seasonal basis (May1 through  
2 October 31) when the golf course is in use.  
3
- 4 7. Upon demand the applicant shall demonstrate compliance with a liquor "Server  
5 Awareness Training Program approved by the State of Alaska alcoholic Beverage  
6 Control Board, such as or similar to the program for techniques in alcohol  
7 management (T.A.M.).  
8
- 9 8. The use of the property by any person for the permitted purposes shall comply  
10 with all current and future federal, state and local laws and regulations including  
11 but not limited to laws and regulations pertaining to the sale, dispensing, service  
12 and consumption of alcoholic beverages and the storage, preparation, sale, service  
13 and consumption of food. The owner of the property, the licensee under the  
14 Alcoholic Beverage Control license and their officers, agents and employees shall  
15 not knowingly permit or negligently fail to prevent the occurrence of illegal  
16 activity on the property.  
17
- 18 9. A copy of the conditions imposed by the Assembly in connection with this  
19 conditional use approval shall be maintained on the premise at a location visible  
20 to the public.  
21
- 22 10. Prior to implementation of the Golf Course license, the applicant shall sell or  
23 transfer the Package store license.  
24
- 25 11. There will be no sign(s) advertising golf course alcohol sales visible from off golf  
26 course property.  
27

28 **Section 4.** Failure to comply with the conditions of this conditional use permit shall  
29 constitute grounds for its modification or revocation.  
30

31 **Section 5.** This resolution shall become effective immediately upon passage and  
32 approval by the Anchorage Assembly.  
33

34 PASSED AND APPROVED by the Anchorage Assembly this 22<sup>nd</sup>  
35 day of October 2002.

ATTEST:

\_\_\_\_\_  
Chair

  
\_\_\_\_\_  
Municipal Clerk

(2002-192)  
(015-261-04)



## 2002-192



Date of Aerial Photography: 2001



# CONDITIONAL USE - LIQUOR

## 2002-192

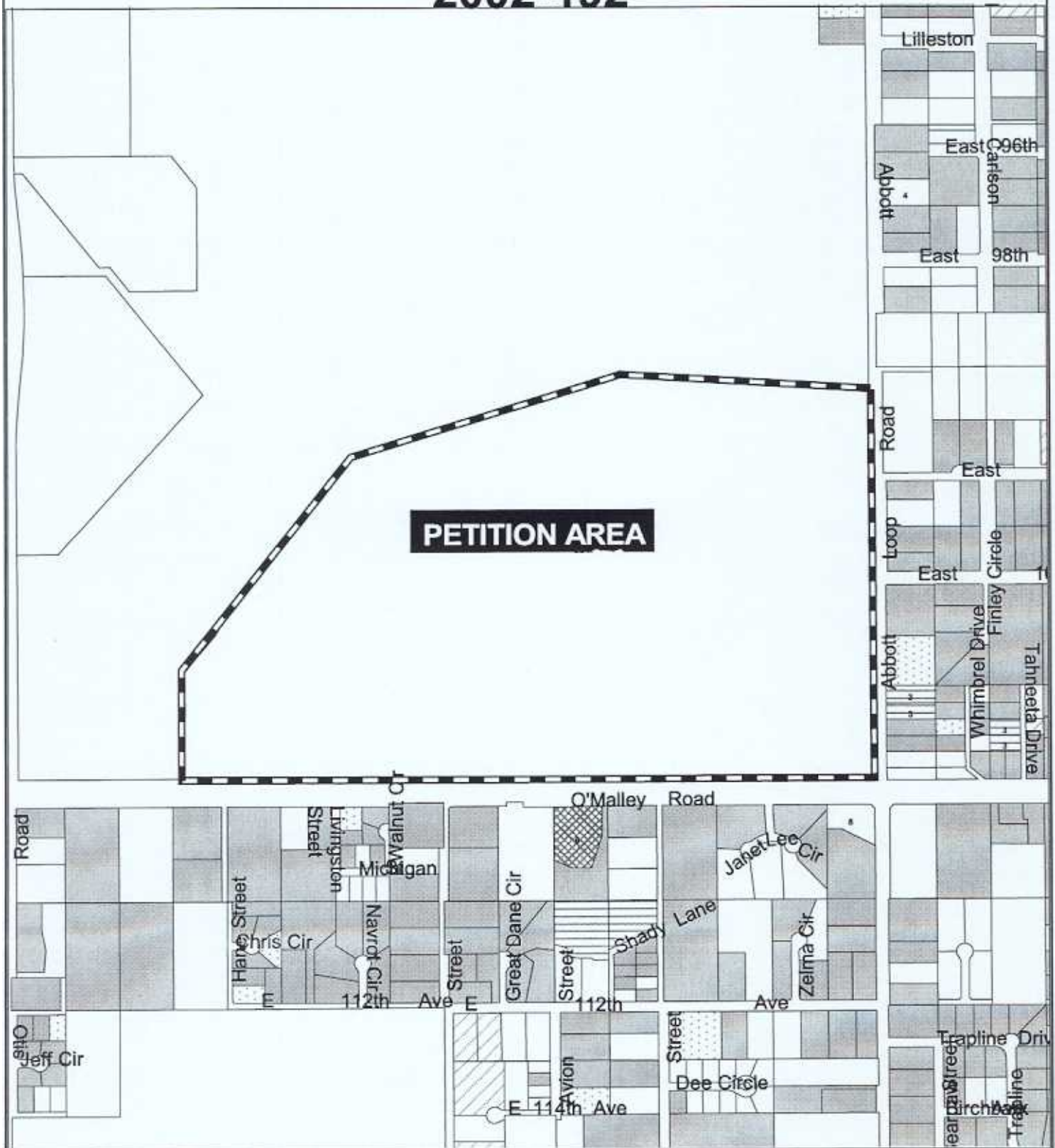

Municipality of Anchorage  
Planning Department



Date: AUGUST 6, 2002

- Single Family Detached
- Single Family Attached, Duplex
- Mobile home
- Multi - Family 3 & 4 Plex
- Multi - Family 5+



Source: Housing Stock based on 1998 Land Use Inventory  
Planning Department, MOA

002



**MUNICIPALITY OF ANCHORAGE  
ASSEMBLY MEMORANDUM**

869

No. AM / -2002

Meeting Date: October 22, 2002

From: Mayor

Subject: AR 2002-319

Alcoholic Beverages Conditional Use for a  
Golf Course Alcohol Liquor License-Seasonal in  
the PLI-p District for Anchorage Golf Course LLC  
per AMC 21.50.160.

1 In December 2001, Seibu Alaska, Inc. d.b.a. O'Malley's On the Green had made  
2 application for a new conditional use permit for an alcoholic beverages use in the PLI-p  
3 District for O'Malley's On the Green Public Golf Course as required by AMC 21.50.160  
4 and for an alcoholic beverages Golf Course Alcohol License-Seasonal (as defined by AS  
5 04.11.115). State statute does not allow an entity owning a new Beverage Dispensary  
6 license to also own a Golf Course license. Seibu has a new Beverage Dispensary license at  
7 the Alyeska Resort. Seibu was advised to form a separate corporation to own the Golf  
8 Course license. Seibu formed Anchorage Golf Course LLC and has reactivated the  
9 application.

10  
11 The applicant (now Anchorage Golf Course LLC) filed an application with the Alcoholic  
12 Beverage Control Board for a new seasonal Golf Course Alcohol License that restricts the  
13 sale of alcohol to beer and wine to the same time and months the golf course is open,  
14 typically 9:00 AM to 9:00 PM, 7-days a week, May to October. Seibu has currently at the  
15 golf course a seasonal Package Store Liquor License located in the downstairs of the  
16 Clubhouse in the Snack Shop; a Beverage Dispensary License, for the upper floor, which  
17 serves the bar, banquet room, restaurant and patio; and is now applying for the Golf Course  
18 license. The new seasonal Golf Course License is intended to replace the Package Store  
19 Seasonal License. The service area for the Golf Course license will be the snack shop and  
20 the golf course itself. [Seibu's Beverage Dispensary license for the clubhouse is a  
21 transferred license and is therefore exempt from AS 04.11.115.]

22  
23 Seibu's existing license conditional use, approved May 16, 1989, has four conditions of  
24 approval that are continued with this conditional use: the products to be sold will be  
25 limited to beer and wine only; the hours of operation shall be limited to the hours the golf  
26 course is in use, not at any other time; the package store will be closed during the winter  
27 months when the golf course is not in use; there will be no sign advertising the package  
28 store on O'Malley Road. The sale of alcoholic beverage represents 32% of gross receipts  
29 compared to 66% sale of food.

30  
31 Aside from the two liquor licenses at the golf course, Beverage Dispensary and Package  
32 store (which will be replaced by the Golf Course license), there are only two other alcohol  
33 licenses within 4,000 feet of this site: a restaurant/eating place license and a package store.  
34 There are three schools within a one-half to one-mile radius. The Parks and Recreation  
35 Division has no objection to this new conditional use or liquor license. The Department of  
36 Health and Human Services has no objection, but does note that the Golf Course license

1 represents a net gain for the Abbott Loop Community Council area (the new Fred Meyer  
2 package store license plus the new Golf Course license). Golf Course licenses are exempt  
3 from State population limits.

4  
5 This conditional use for alcoholic beverages in the PLI-p District for a golf course use and  
6 new liquor license generally meets the required standards of Title 21.  
7

Reviewed by:



Harry J. Kieling Jr.  
Municipal Manager

Reviewed by:

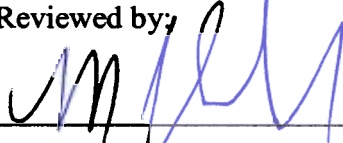

for Craig E. Campbell, Executive  
Director Office of Planning, Development  
and Public Works

Respectfully submitted,

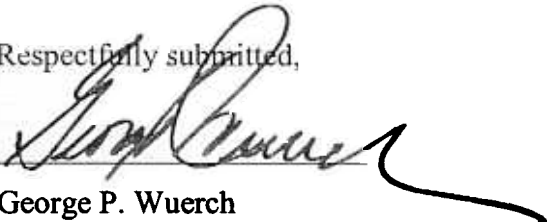

George P. Wuerch  
Mayor

Prepared by:

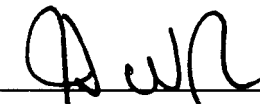

for Susan R. Fison, Director  
Department of Planning

Municipality of Anchorage  
MUNICIPAL CLERKS OFFICE  
Agenda Document Control Sheet

AR 2002-319

<b>1</b>	<b>SUBJECT OF AGENDA DOCUMENT</b>  Conditional Use for an Alcoholic Beverage Use in the PLI-p District for Anchorage Golf Course, LLC for a Golf Course Alcohol License-Seasonal per AMC 21.50.160; located on Section Sixteen Subdivision, Tract C; generally located on the north side of O'Malley Road between Lake Otis Parkway and Abbott Loop Road.  (Abbott Loop Community Council) (Case 2002-192)	<b>DATE PREPARED</b> 09/16/02	<b>INDICATE DOCUMENTS ATTACHED</b> <input type="checkbox"/> AO <input checked="" type="checkbox"/> AR <input checked="" type="checkbox"/> AM <input type="checkbox"/> AIM
<b>2</b>	<b>DEPARTMENT NAME</b> Planning Department	<b>DIRECTOR'S NAME</b> Susan R. Fison, Director	
<b>3</b>	<b>THE PERSON THE DOCUMENT WAS ACTUALLY PREPARED BY</b> Jerry Weaver	<b>HIS/HER PHONE NUMBER</b> 343-4215	
<b>4</b>	<b>COORDINATED WITH AND REVIEWED BY</b>	<b>INITIALS</b>	<b>DATE</b>
<b>5</b>	<b>Mayor</b> Heritage Land Bank Merrill Field Airport Municipal Light & Power Port of Anchorage Solid Waste Services Water & Wastewater Utility		
<b>4</b>	<b>Municipal Manager</b> Cultural & Recreational Services Employee Relations Finance, Chief Fiscal Officer Fire Health & Human Services Office of Management and Budget Management Information Services Police	<i>M</i>	9/26
<b>2</b>	Office of Planning, Development, & Public Works Development Services Facility Management	<i>Attorn</i>	9/10/22
<b>1</b>	Planning Project Management & Engineering Street Maintenance Traffic Public Transportation Department Purchasing	<i>PAF</i>	9-18-02
<b>3</b>	<b>Municipal Attorney</b> 1391 <b>Municipal Clerk</b>	<i>Sh</i>	9-24-02
<b>5</b>	<b>SPECIAL INSTRUCTIONS/COMMENT</b>  Pre-advertised for 10/22/02 Assembly meeting		
<b>6</b>	<b>ASSEMBLY MEETING DATE REQUESTED</b> asap	<b>7</b>	<b>PUBLIC HEARING DATE REQUESTED</b> 10/22/02

RECEIVED  
 HD  
 02 SEP 19 AM 10:11